

DFB-LD for Gas Sensing

TO5 with TEC

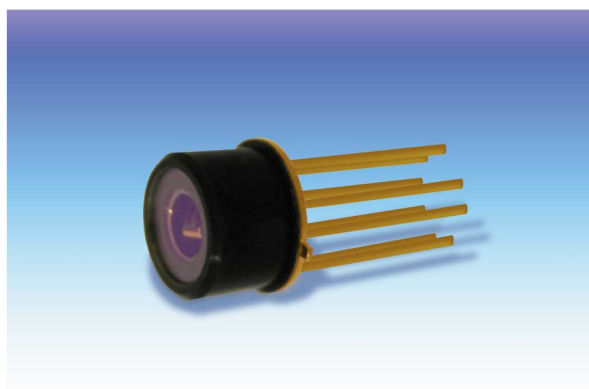

14-pin Butterfly



Telecom-band

Wavelength band	Wavelength	Package		
		TO5 with TEC	14-pin Butterfly	
			10 mW	10 mW
O-band	1260-1360 nm	NLK1B5EAYF	NLK1B5EAAA	NLK1B5GAAA
E-band	1360-1460 nm	NLK1E5EAYF	NLK1E5EAAA	NLK1E5GAAA
S-band	1460-1530 nm	NLK1S5EAYF	NLK1S5EAAA	NLK1S5GAAA
C-band	1530-1565 nm	NLK1C5EAYF	NLK1C5EAAA	NLK1C5GAAA
L-band	1565-1625 nm	NLK1L5EAYF	NLK1L5EAAA	NLK1L5GAAA
UL-band	1625-1670 nm	NLK1U5EAYF	NLK1U5EAAA	(NLK1U5FAAA) (15 mW)
UL(+)-band	1670-1690 nm	-	NLK1U5EAAA (1670-1690)	-

Longer wavelength

Wavelength	Package	
	TO5 with TEC	14-pin Butterfly
1735-1800 nm	KELD1F5EAYF (10 mW)	KELD1F5DAAA (5 mW)
1865-1890 nm 1995-2015 nm	KELD1G5DAYF (5 mW)	KELD1G5BAAA (2 mW)
Near 2050 nm	KELD1G5DAYF (2050) (5 mW)	KELD1G5BAAH (2050) (2 mW)
Near 2120 nm	KELD1G5BAYF (2120) (2mW)	KELD1G5BAAH (2120) (2mW)
Near 2330 nm	KELD1G5BAYF (2330) (2 mW)	KELD1G5BAAH (2330) (2 mW)

DFB-LD for Gas Sensing

Outline diagram (mm)

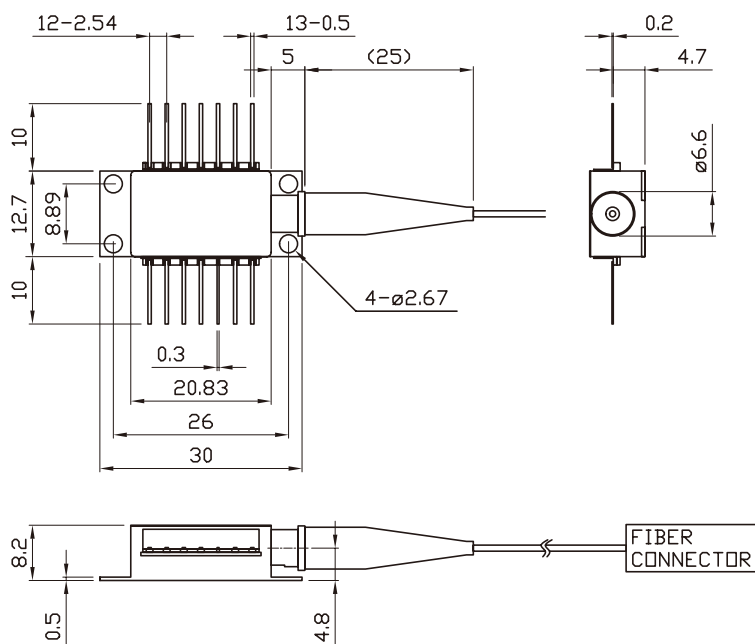

Schematic drawing

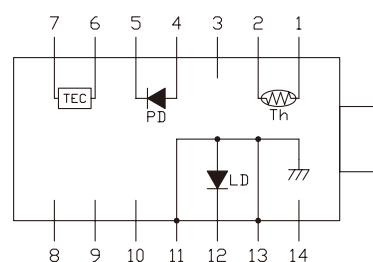

Pin connection

No	Description	No	Description
1	Thermistor	8	NC
2	Thermistor	9	NC
3	NC	10	NC
4	PD Anode (-)	11	Case Ground (LD Anode)
5	PD Cathode (+)	12	LD Cathode (-)
6	Cooler (+)	13	Case Ground (LD Anode)
7	Cooler (-)	14	NC

Outline diagram (mm)

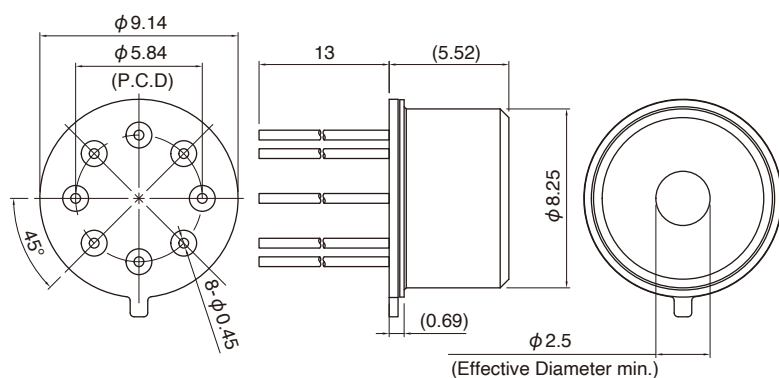

Schematic drawing

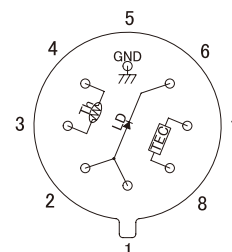

Pin connection

No	Description	No	Description
1	LD Anode (+)	5	Ground
2	LD Anode (+)	6	LD Cathode (-)
3	Thermistor	7	Cooler (+)
4	Thermistor	8	Cooler (-)

All statements, technical information and recommendations related to the products herein are based upon information believed to be reliable or accurate. However, the accuracy or completeness thereof is not guaranteed, and no responsibility is assumed for any inaccuracies. NTT Innovative Devices reserves right to change at any time without notice the design, specifications, function, fit or form of its products described herein, including withdrawal at any time of a product offered for sale herein.



NTT Innovative Devices Corporation

Aquaria Tower Yokohama, 1-1-32 Shin-urashimacho,
Kanagawa-ku, Yokohama-shi, Kanagawa, 221-0031, Japan
E-mail: opt-tec@ntt-el.com
<https://www.ntt-innovative-devices.com/en/>



Sensing application
website



Please use our products in accordance with the instructions provided in the manual, user's guide or specifications attached. Exporting our products or technologies may be subject to the Foreign Exchange and Foreign Trade Law of Japan and export control acts and regulations of other related countries.